

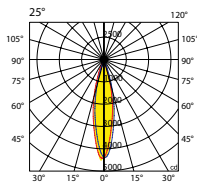

Photometric data:

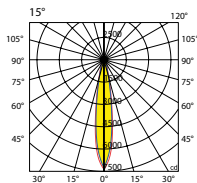
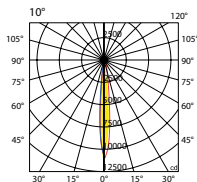

ORION INTERNATIONAL Features

- It's suitable for buildings, bridges, statues, parks, squares, etc.
- Thick, fashionable and compact appearance; ADC 12 die cast aluminum lamp body of **high** density material; Anti-UV and anti-corrosion outdoor spraying treatment
- **Whole** structure waterproofing design technology
- 4mm safety toughened glass with **high** transmittance

ORION INTERNATIONAL Product Size

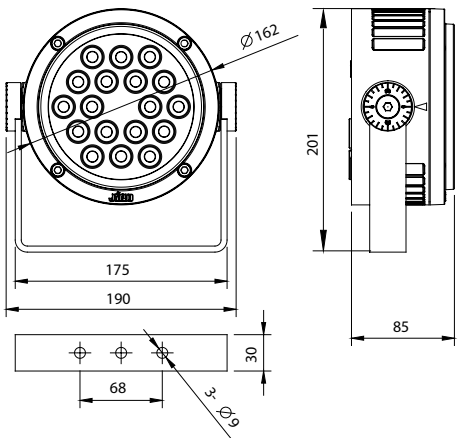

OLD-OT3

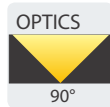
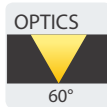
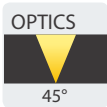
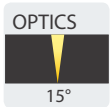
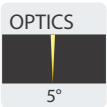

ORION INTERNATIONAL Performance parameter

LED Light Source: Cree, Lumileds, Osram, Epistar	Effects: single color, full color, gradient, chasing, flowing
Color Temperature: Single color , RGB, RGBW, RGBA、RGB+W	Protection Grade: IP65
LED CRI: ≥ 80 R9>0	Electrical Safety Grade: Class I / III
Lifespan: ≥ 50000h	Voltage: AC220V 50/60Hz DC24V
Beam Angle: 3~110° (Optional)	Current: constant current drive
Rotation Angle: 220°	Working Temperature: -35℃ ~ +45℃
Control Mode: ON/OFF、DMX512	Mounting Bracket: customizable

ORION INTERNATIONAL Optional accessories



Lens Hood



Honeycomb Panel



Ground Stake

ORION INTERNATIONAL Product number

Model	Power	Input Voltage	LED Quantity	Single LED Power	Color
OLD-OT3-D	12~30W	AC220V/DC24V	12/15/18	1~3W	single color
OLD-OT3-R	12~36W	DC24V	12/15/18	1~4W	full color